

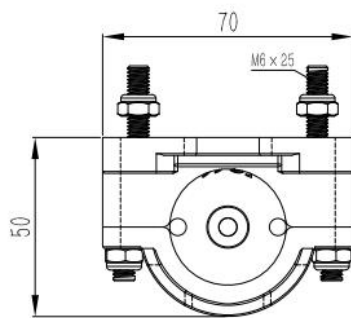

- IP 69K
- Anti-Shocks 50G
- Anti-Vibration
- Low Latency

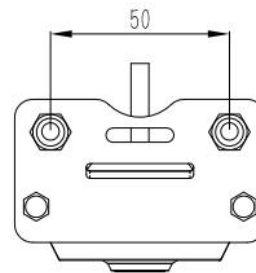
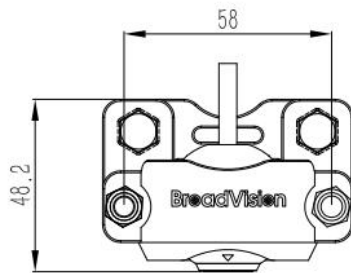

Unit: mm

Product Data

TECHNICAL DATA

Camera Robos-A

Sensor	Camera 1/2.9 CMOS digital image sensor
Resolution	Max. 1920×1080(FULL AHD)
Lens Angle	Horizontal 80°±5°; Vertical 50°±5°; Diagonal 87°±5°
Min Illumination	0.1Lux
Video Signal	NTSC=1920H x 1080V 30fld/s
TV Aberration	-14.8%
Optical Axis Accuracy	±15pixel
Horizontal Center Resolution	>700TVL
Exposure Control	AEC
Gain Control	AGC
Start Up time	<2s
Structure	Mechanical Aviation aluminum housing, which is suitable for outdoor heavy industrial environments with high requirements for shock and vibration
Corrosion Protection Level	Salt spray cycle test in accordance with IEC 60068-2-52
Ingress Protection	IP68 (IEC60529 standard) dust and water resistance, 30 minutes immersion in 1m of water, IP69K (DIN 40050-9) withstand high-pressure cleaning: 14-16L/min 80°C and 100 bar
Interior Padding	Camera is potted with Polyurethane elastomer
Vibration Resistance Rating	50G pulse, 11ms half-sine wave
Mounting Bracket Operating Temperature	Stainless steel bracket, 3-in-1 bolt. Suitable for hoisting and wall mounting. -30°C to +70°C
Storage Temperature	-40°C to +85°C
Product Weight	<0.2kg
Input Voltage	Electrical 12V
Power Consumption	1W
Jacket Diameter	Cable Technical Data Polyurethane, flame retardant, halogen-free, black φ9.1±0.2mm, 0.8mm thick
Separator Tape	Polyester fleece
Overall Shielding Conductors	Tinned copper, 0.1mm thick, 85% braided Tinned copper, padded with cotton
Insulation Resist	20MΩ/Km min (20°C)
Bending Radius	When bending continuously: 5 times the diameter; Optimal bending radius: 10 times the diameter
Working Voltage	450V
Temperature	-40°C to +90°C
Test Voltage	Conductor/Conductor: 2500V, Conductor/Shield: 1500V
Approval	EN 60811-2-1(Oil Resistant); IEC 60332-2(fire-resistant), RoHS- II ; IEC 60754(halogen-free)
Authentication	CE和FCC

Electrical Connections

Front side of molded 4p male connector

1 = Coax core	= Video signal
2 = Coax screen	= Video GND
3 = Red	= 12V/DC
4 = Black/orange	= 0V
Shielding	To connector housing

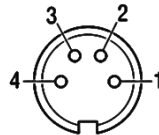

All data subject to change without notice. All dimensions are for commercial purpose only.
The camera from BroadVision comply with the latest CE, FCC, BIS, EMC and mirror-directive regulations, where applicable.
All products are manufactured in accordance with the ISO 9001 quality management system, ISO 14001 environmental management systems and ISO 45001 occupation health safety management system, where applicable.

Outdoor Heavy Industry Camera

BroadVision
<http://www.bvcameras.com>